

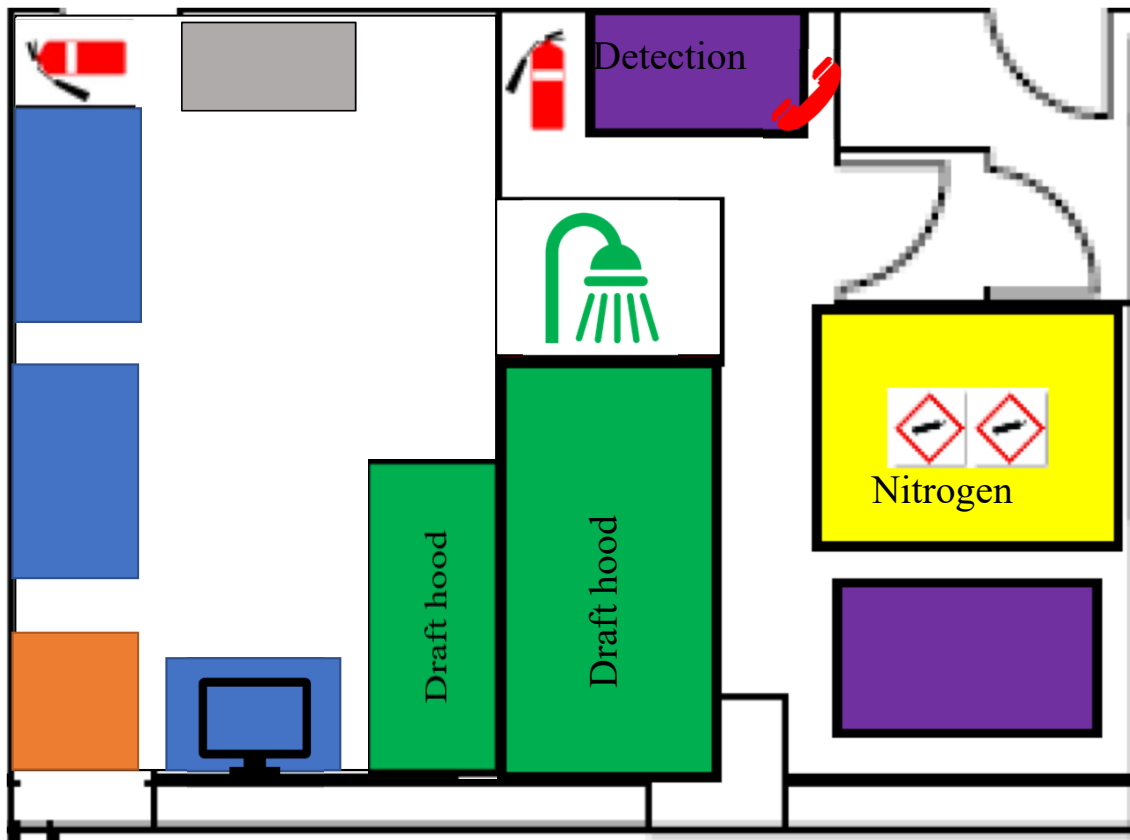



Clean Room Floor Plan



 : Emergency Intercom

 : Eyewash and pull station

 : Instrument

 : Drying oven

 : First aid kit

國立清華大學實驗場所事故應變通報聯絡圖

103.09.30 修訂

國軍新竹地區醫院 (空軍醫院) : 5348181	台大醫院新竹分院 : 5326151	新竹馬偕醫院 : 5166868、6119595
埔頂派出所 : 5773899	南門綜合醫院 : 5261122	東元綜合醫院 : 5527000
環保署環境事故專業諮詢中心 : 0800-055119、0800-057119		
毒化物醫療與諮詢 : 台北榮總臨床毒物科電話 : 02-2875-7525 / 自動傳真回覆系統 : 02-2874-2929 Fax : 02-2873-9193		

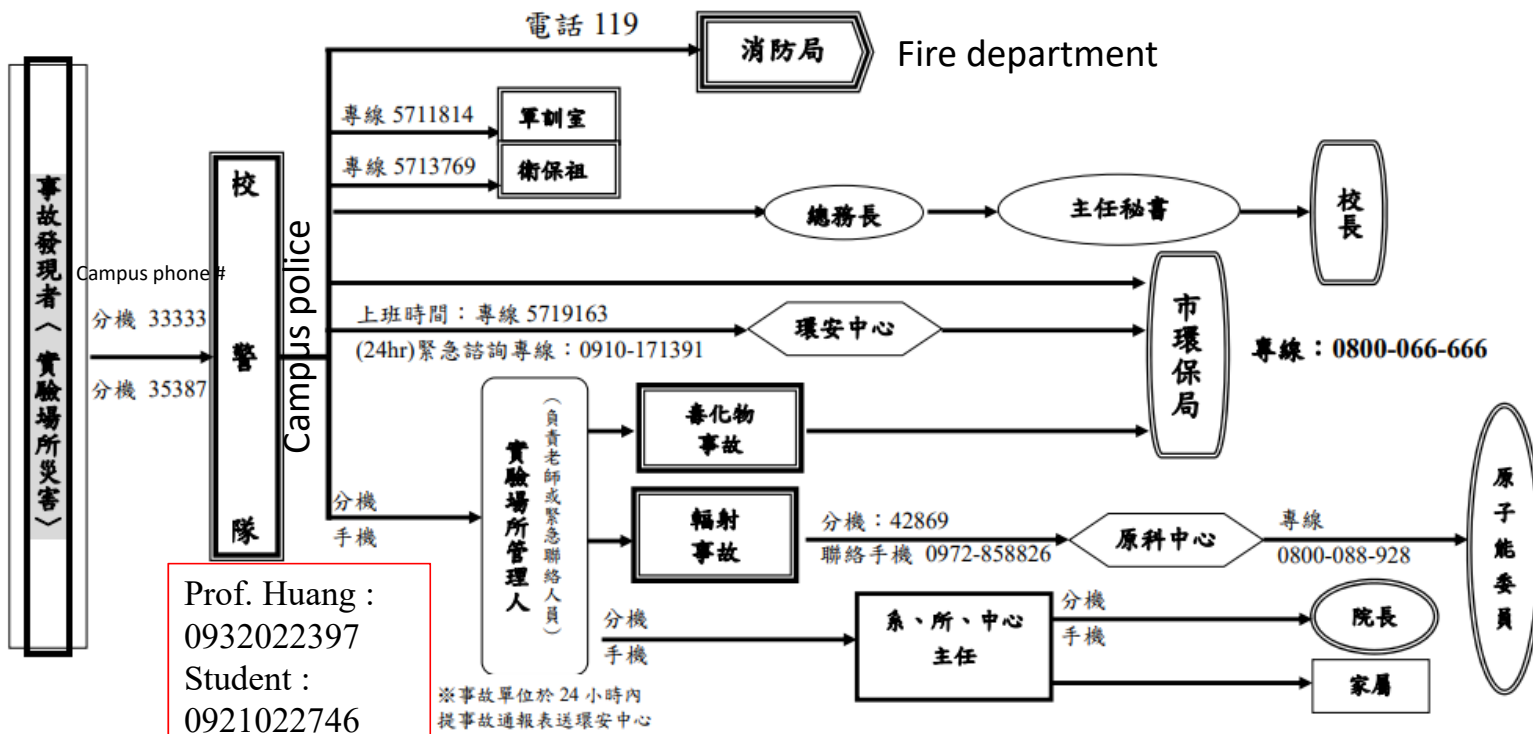

Prof. Huang :
 0932022397
Student :
 0921022746

※事故單位於 24 小時內
提事故通報表送環安中心

- 請校警隊執勤同仁確認實驗室如為毒性化學物質運作場所，則最遲於事故發生一小時內，請通報新竹市環保局 (0800-066666 ; 5368920)
- 各單位分機及緊急聯絡電話(手機)請自行填入空白欄位。
- 北區勞工檢查所 (02) 23213511。

Emergency Contacts and Procedure

In the event of a fire or a HAZMAT emergency

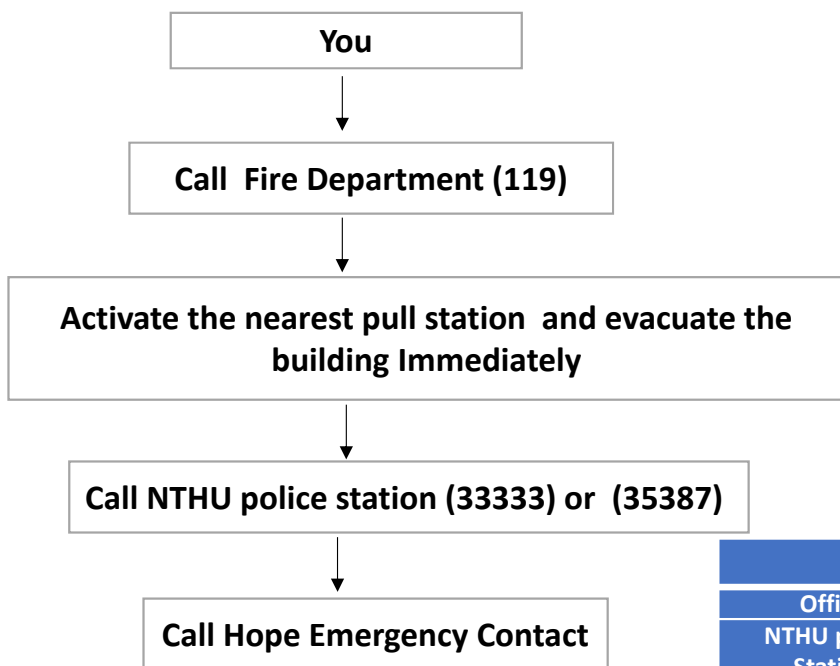

Information to provide fire and police dispatcher

Use the following statement to provide the necessary information to the 119 dispatcher:

This is _____ calling from 光電實驗館
(Caller's name)

There has been an incident which requires emergency service. The Phone number here is _____. The situation is _____
(briefly explain the situation, i.e., fire, injured person, etc.) Do not hang up until 119 dispatcher says you may.

Emergency Contact Information	
Office	Phone
NTHU police Station	33333 (From Campus phone) 03-516333 (From cell phone or off-campus phone)
Fire Department	0-119 (From Campus phone) 119 (From cell phone or off-campus phone)
Police Department	0-110 (From Campus phone) 110 (From cell phone or off-campus phone)

HOPE Lab Emergency Response Team	
Name	Mobile
Prof. Yen-Chieh Huang	0953-022397
Bao Dong	0921-457497
Guo Chang He	0921-022746
Jacky Lin	0931-088029
LIOU,ZIH-CI	0918-028188

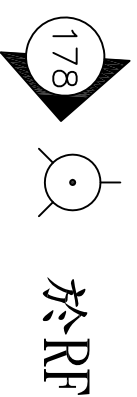
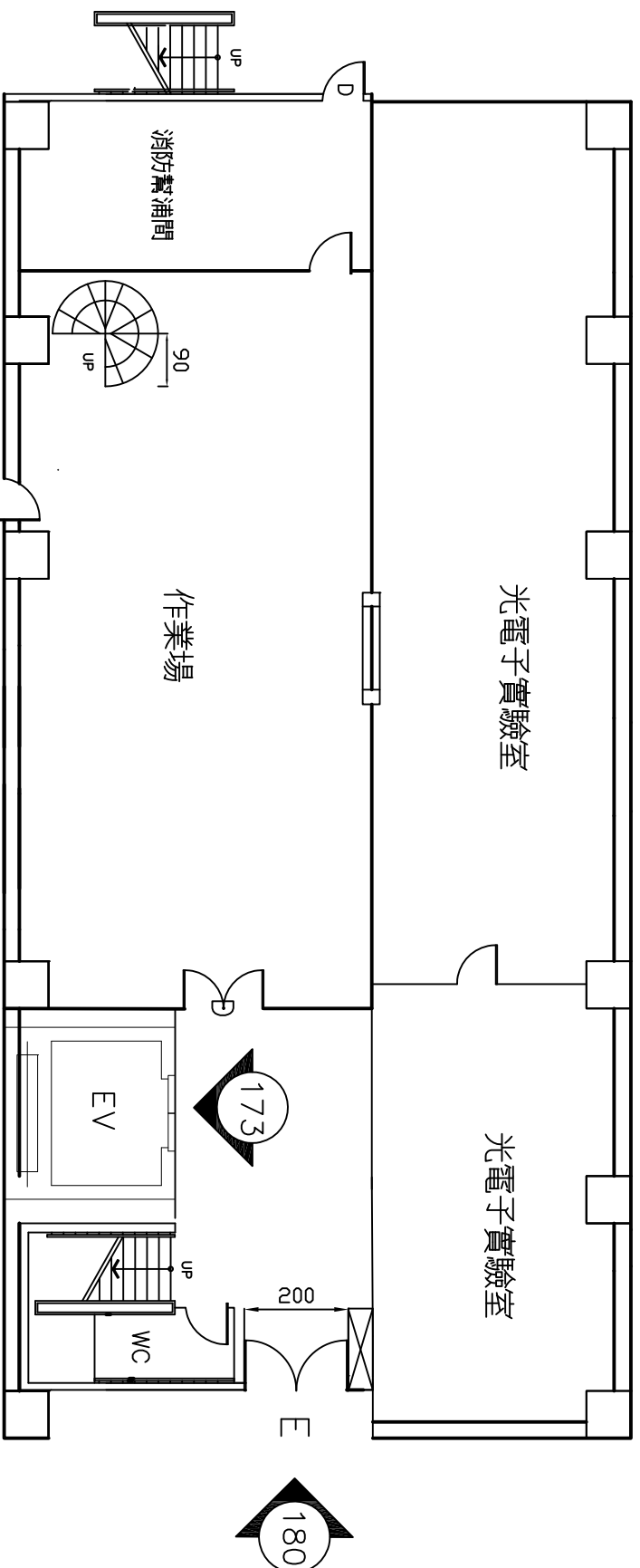

一樓平面圖

光電實驗館

防火避難設施檢查紀錄簡圖

國立清華大學

大台北建築物安全檢查股份有限公司

電話: (04) 22292836 傳真: (04) 22292856

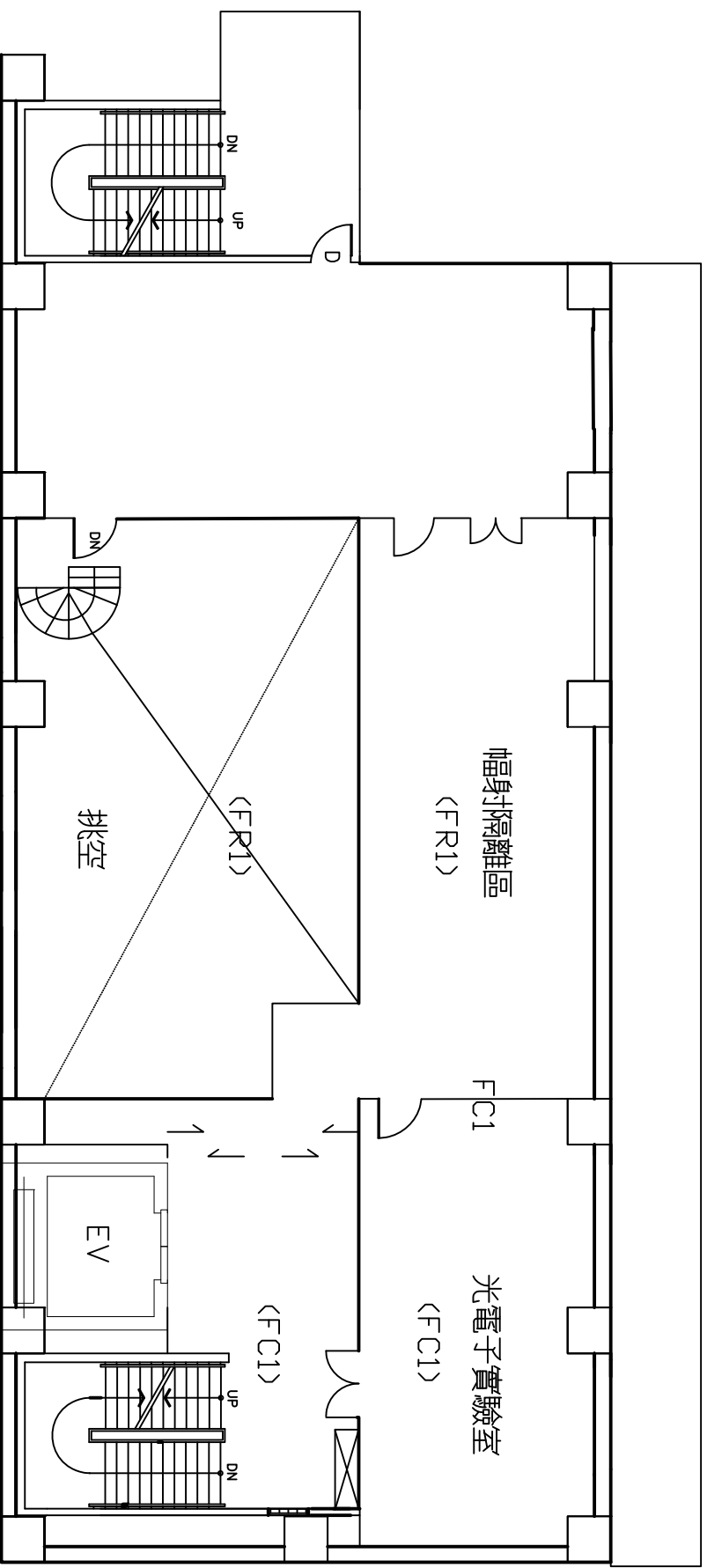

二樓平面圖

防火避難設施檢查紀錄簡圖

光電實驗館

國立清華大學

大台北建築物安全檢查股份有限公司
 電話：(04)22292836 傳真：(04)22292856

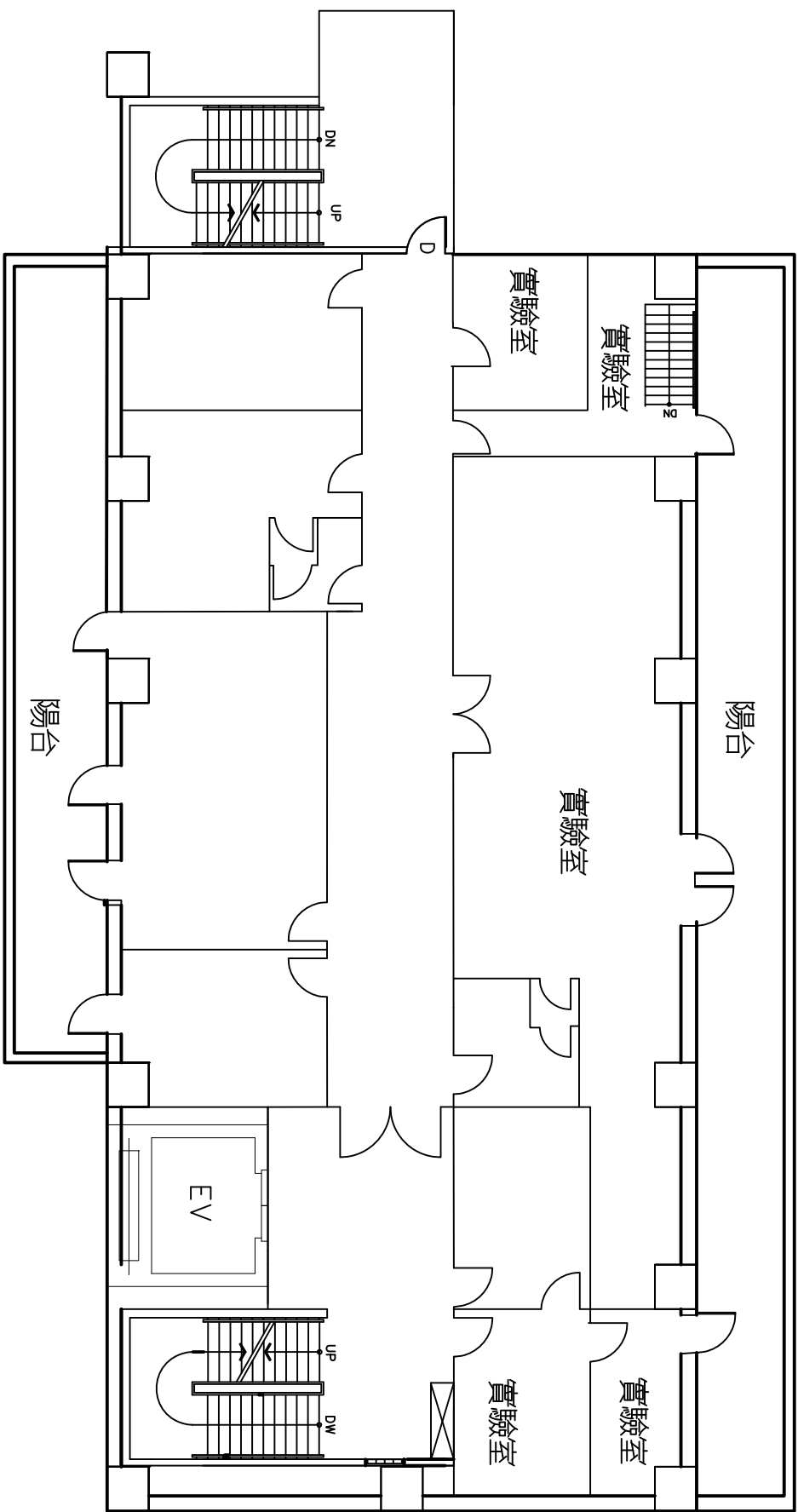

三樓平面圖

光電實驗館

防火避難設施檢查紀錄簡圖

國立清華大學

大台北建築物安全檢查股份有限公司

電話：(04)22292836 傳真：(04)22292856

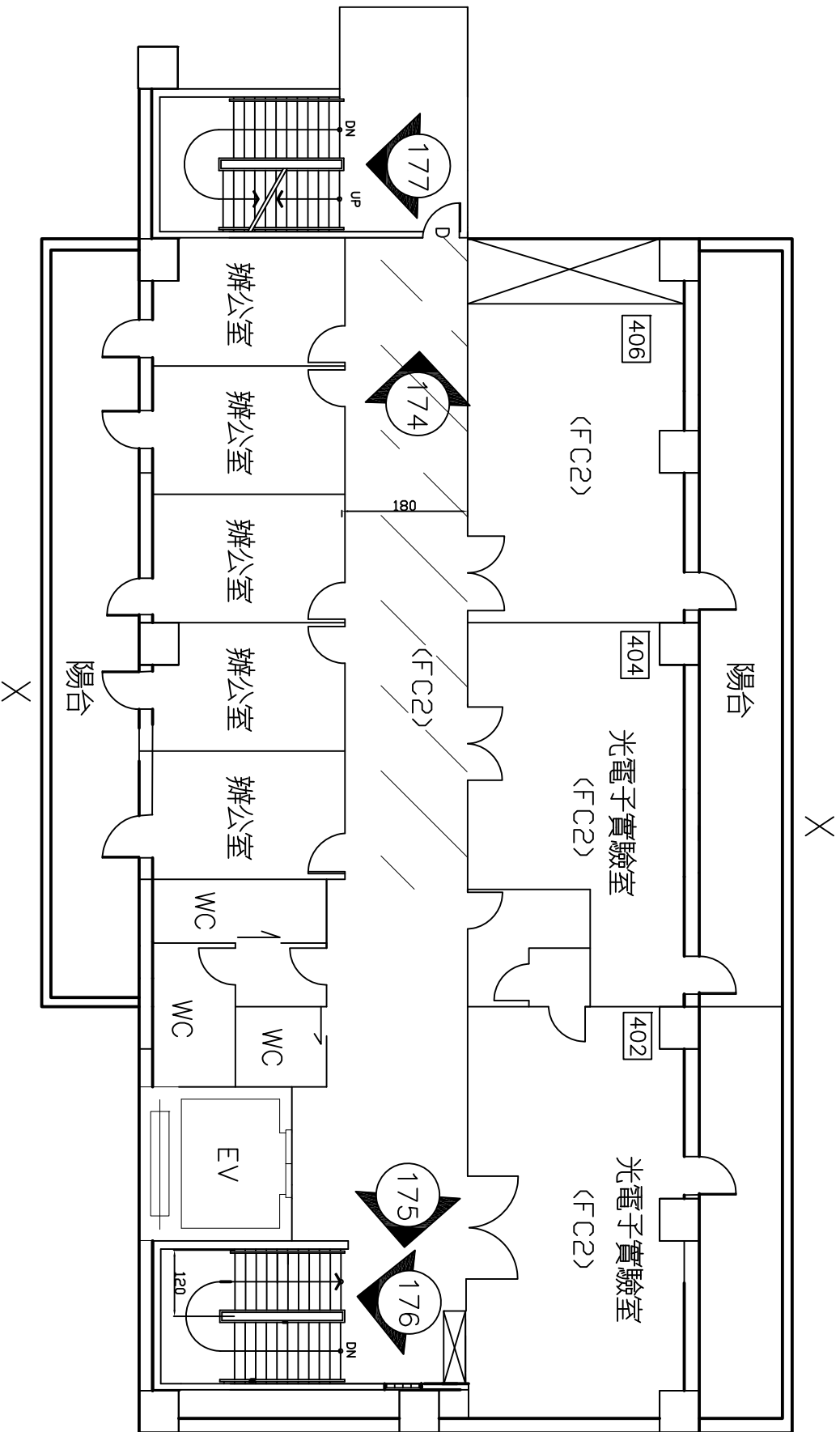

四樓平面圖

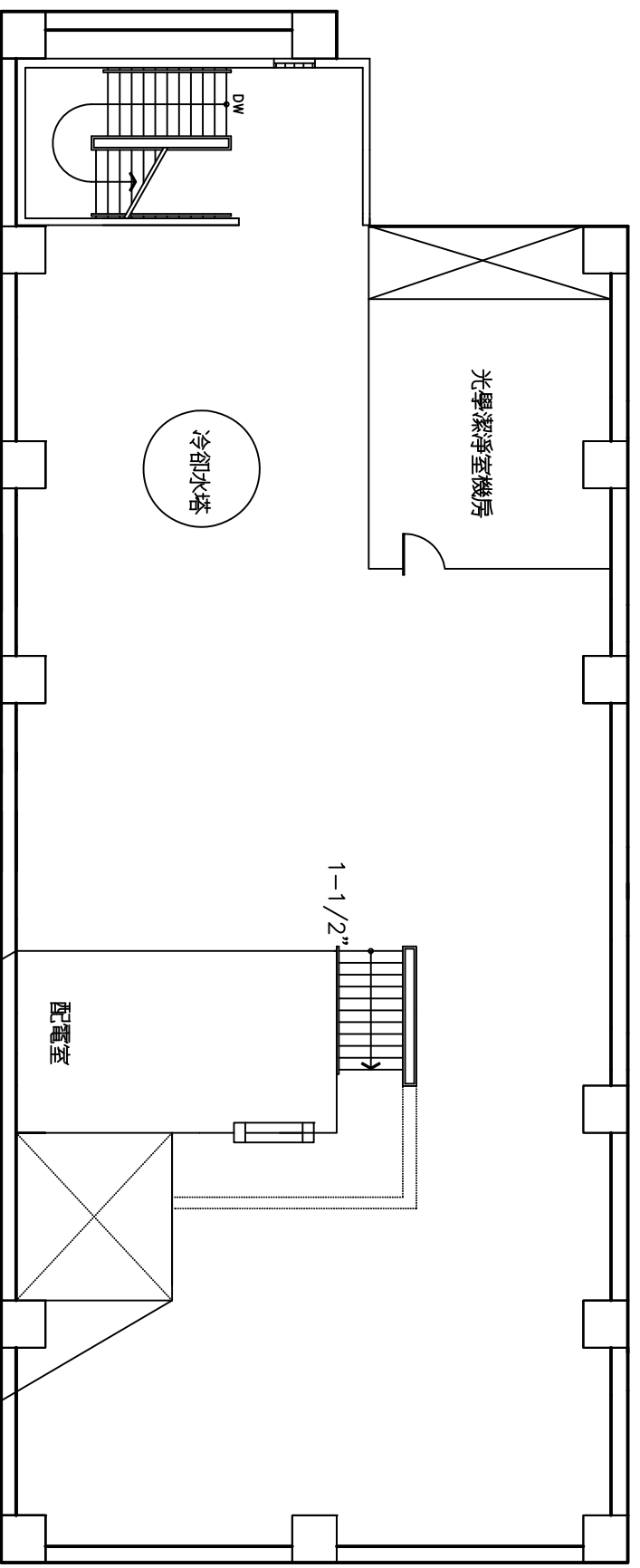

RF 平面圖

光電實驗室

防火避難設施檢查紀錄簡圖

國立清華大學

大台北建築物安全檢查股份有限公司

電話: (04) 22292836 傳真: (04) 22292856